

WATER LEAK SENSOR 1

Model YS7903-UC

YOLINK

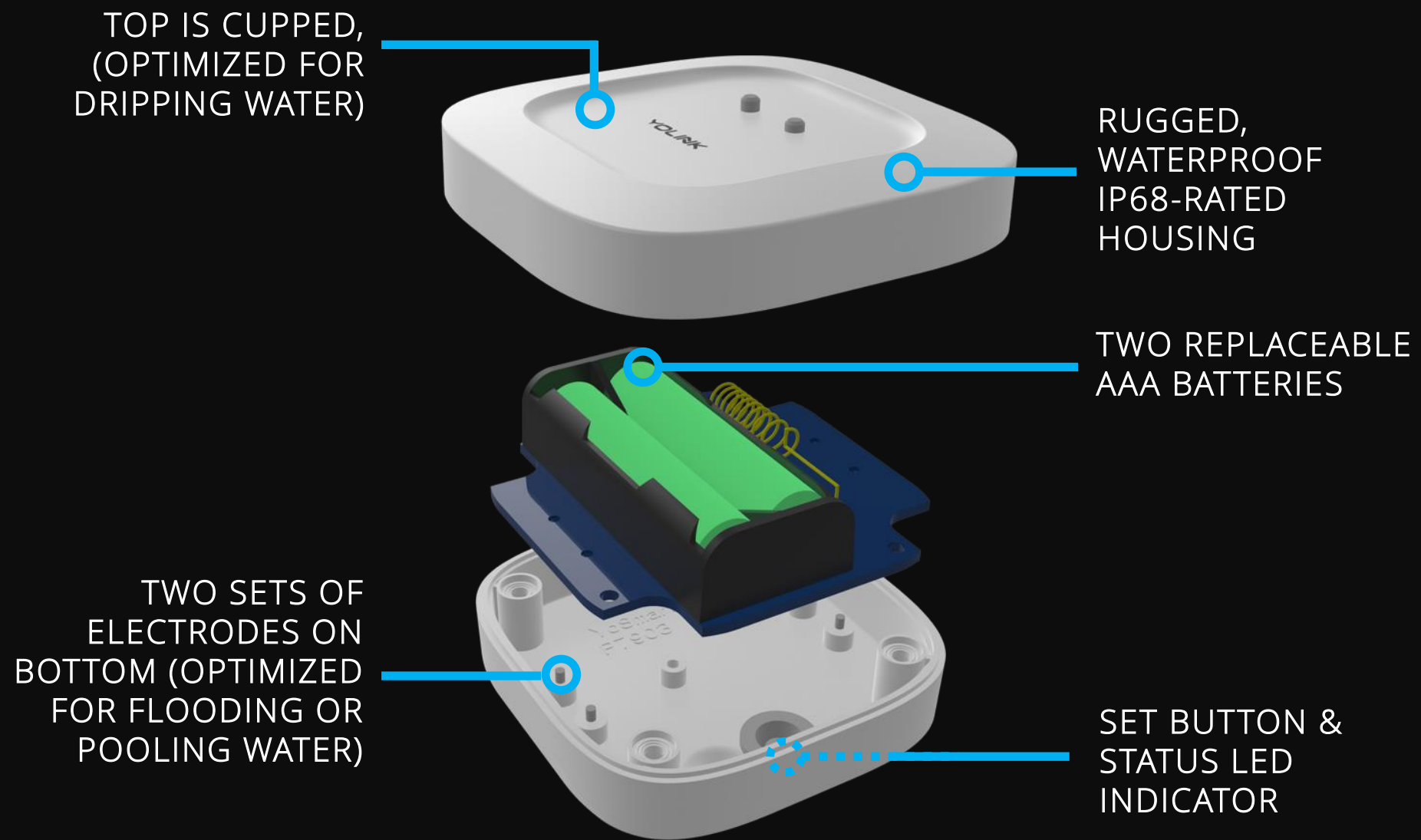

DIMENSIONS:

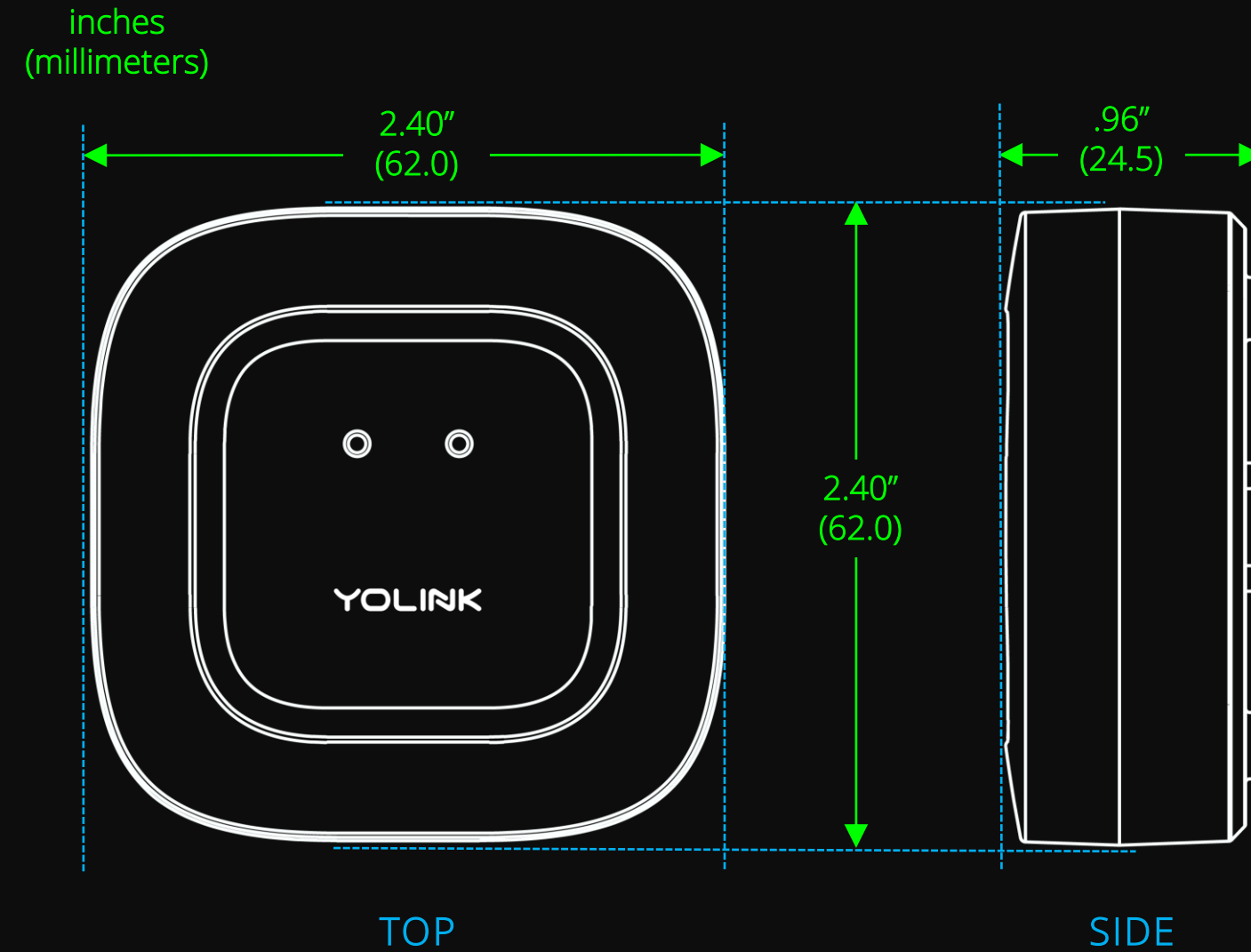

SUMMARY:

A self-contained and waterproof water leak and flood sensor, wireless, using YoLink's LoRa®-based wireless technology. This sensor is ideal for both water dripping and flooding or pooling water. Applications includes water detection at toilets, tubs, showers, sinks, water heaters, dishwashers, laundry machines, ice machines, fridge/freezers, hot water heaters, sump pumps, hot tubs, and aquariums.

STANDARD YOLINK PRODUCT FEATURES:

¼ mile open-air wireless range, long battery life, easy installation using Scan & Play (QR code scan via the app; adds the device to your app instantly), no reliance on WiFi, offline functionality with Control-D2D device-to-device pairing

SPECIFICATIONS:

Color: White

Operating Temperature Range: 32°F - 122°F (0°C - 50°C)
(Intended for Indoor Use, Only)

Voltage: 3 VDC (Powered by Two AAA Batteries, Included)

Expected Battery Life: 5+ Years

RELATED PRODUCTS:

YS7904-UC Water Leak Sensor 2 & 3