

Valve Controller 2 & Bulldog Valve Robot Kit

YS5003-UC & BULLDOG

Quick Start Guide
Revision Mar. 15, 2023

A Welcome!

Thank you for purchasing YoLink products! We appreciate you trusting YoLink for your smart home & automation needs. Your 100% satisfaction is our goal. If you experience any problems with your installation, with our products or if you have any questions that this manual does not answer, please contact us right away. See the Contact Us section for more info.

Thank you!

Eric Vanzo
Customer Experience Manager

The following icons are used in this guide to convey specific types of information:



Very important information
(can save you time!)



Good to know info but may not apply to you



Fr

Pour des instructions en français, scannez les codes QR dans la section suivante.



Es

Para obtener instrucciones en español, escanee los códigos QR en la siguiente sección.

B Before You Begin

Please note: this is a quick start guide, intended to get you started on the installation of your Valve Controller 2 and Bulldog Valve Robot Kit. Download the full Installation & User Guide by scanning this QR code:



Installation & User Guide

You can also find all current guides and additional resources, such as videos and troubleshooting instructions, on the Valve Controller 2 and Bulldog Valve Robot Kit Product Support Page by scanning the QR code below or by visiting:

<https://shop.yosmart.com/pages/valve-controller-2-product-support>



Product Support
Support produit
Soporte de producto



Please note: the existing ball valve must be in good working order. It must open and close smoothly, with minimal effort, and it must close fully, shutting off the water completely. The Bulldog Valve Robot is not able to correct mechanical issues of the ball valve.

Your Valve Controller 2 wirelessly connects to the internet via a YoLink Hub or SpeakerHub, and it does not directly connect to your WiFi or local network. In order for remote access to the device from the app, and for full-functionality, a YoLink hub is required. This guide assumes the YoLink app has been installed on your phone, and a YoLink Hub or SpeakerHub is installed and online.

If installing the Valve Controller 2 and Bulldog Valve Robot outdoors, please refer to the environmental range specifications found on the Valve Controller 2 product support page. While these devices can be installed outdoors, it should be protected from rain and direct sunlight by an enclosure or overhead cover, such as a rain hood.

C In the Kit

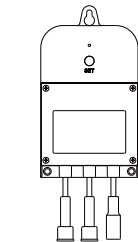

Valve Controller 2

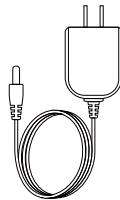

Plug-in Power Supply

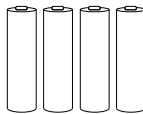

4 x AA Batteries
(Pre-Installed)



Phillips Head
Screws(3)

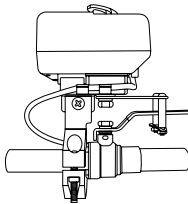

Bulldog Valve
Robot

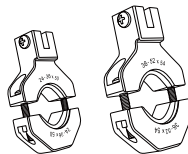

Large & Small
Brackets

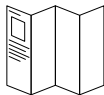

Quick Start Guide

D Required Items

These tools or items may be required:



Drill with Drill Bits

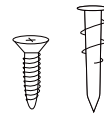

Wall Anchors

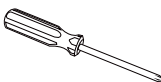

Medium Phillips
Screwdriver

E Get to Know Your Valve Controller 2

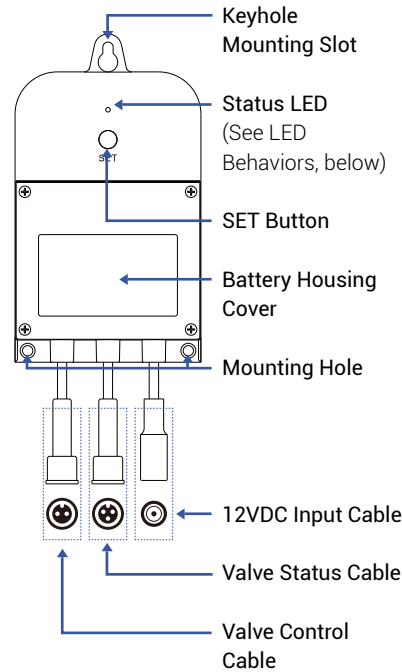

LED Behaviors

- Blinking Red Once, Then Green Once
Device Start-Up
- Blinking Red And Green Alternately
Restoring to Factory Defaults
- Blinking Red Once
Valve Closing
- Quick Blinking Red Twice
Valve is Closed (YS5003S, Only)
- Blinking Green Once
Valve Opening
- Quick Blinking Green Twice
Valve is Open (YS5003S, Only)
- Slow Blinking Green Twice
Connecting to Hub
- Quick Blinking Green
Control-D2D Pairing in Progress
- Quick Blinking Red
Control-D2D Unpairing in Progress
- Slow Blinking Green
Updating
- Fast Blinking Red Once Every 30 Seconds
Low Battery, Replace Batteries Soon

F Get to Know Your Bulldog Valve Robot

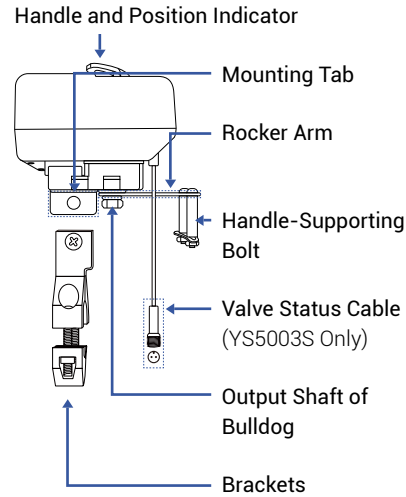

G Add Your Valve Controller 2 to the App

1. Tap **Add Device** (if shown) or tap the scanner icon:

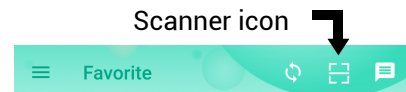

2. Approve access to your phone's camera, if requested. A viewfinder will be shown on the app.

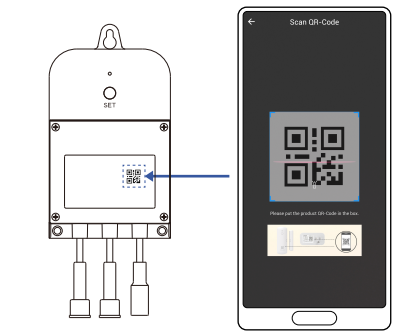

3. Hold the phone over the QR code so that the code appears in the viewfinder. If successful, the **Add Device** screen will be displayed.

4. Follow the instructions to add your Valve Controller 2 to the app.



Install the Valve Controller 2

Preparing for installation:

Determine where you will install your Valve Controller 2. Typically, it should be wall-mounted, no farther away from the Bulldog Valve Robot than the length of the cables allow (if you have purchased optional extension cables, the valve controller can be installed at a location separate from the Bulldog Valve Robot).

Note: use of the 12VDC power adapter is optional. If not used, batteries are required. If the power adapter is used, batteries are optional.

Determine how you will mount the valve controller to the wall, and have hardware and anchors appropriate for the wall surface on hand.

1. Mark the location of the hole for each of the valve controller's three mounting points on the wall. Install anchors, if applicable, per the anchor manufacturer's instructions. Insert the screw for the topmost mounting point, leaving enough space to hang the controller.

2. Hang the controller on this top screw, then insert the two remaining screws into their respective anchors or locations.

3. Tighten all three screws, ensuring the valve controller is secured to the wall.



Install the Bulldog Valve Robot

1. Select the appropriate bracket for your application. The appropriate bracket fit over the ball valve, and will allow for clamping securely to it when the screws are tightened. If the bracket does not fit over the ball valve or seems to be too loose, use the other bracket.

2. Loosen the two screws, to separate the bracket into two pieces, as shown.

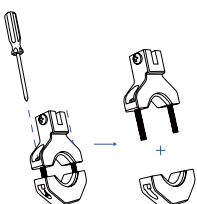

Install the Bulldog Valve Robot, Continued.

3. Place the upper bracket and lower bracket on the valve, as shown, and loosely tighten the screws.

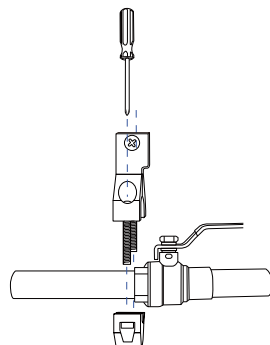

4. Position the bracket so that it is aligned with the pivot point of the ball valve, by visualizing a line between the tab slot and the pivot point, as shown.

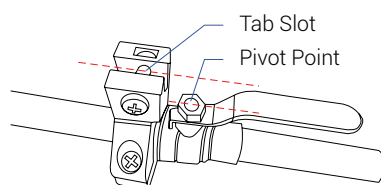

5. Remove the screw from the tab slot, then attach the Valve Robot to the bracket.

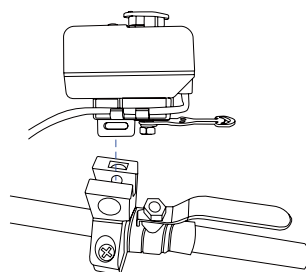

6. Keeping the center axis of the Valve Robot's motor shaft aligned with the ball valve shaft, as indicated by the red dashed line, reinsert and tighten the tab slot screw.

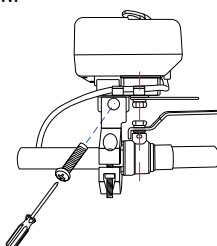

If it is not possible to align the parts as shown, or if the bracket can not be secured to the ball valve, consider rotating the ball valve handle 180°. After removing the Bulldog, this can be done by removing the ball valve handle, and then reinstalling it on the other side. Reinstall the Bulldog (on the other side of the ball valve) and check if alignment is better in this position.

7. Securely tighten the two screws on the bracket. Gently tug on the Bulldog, and tighten the screws until the Bulldog is firmly held in place by the bracket and tab screw.

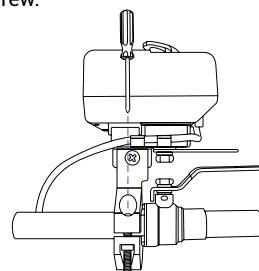

8. Remove the nuts and collars from the two handle supporting bolts, as shown.

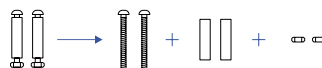

9. Place the bolts in the slot on the rocker arm, with one on each side of the valve handle, as shown.

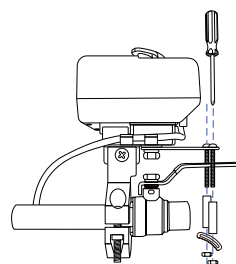

10. Put the collars back on the bolts. Holding them in place with one hand, insert the bottom supporting bracket over the end of each bolt, as shown. Insert and loosely tighten a nut on each bolt. Now, position each bolt/collar so that it is snug against the valve lever handle, with one on each side of the handle. Using a Phillips screwdriver, tighten the screw on each bolt/collar assembly, holding the nut in place, as needed. Confirm that each collar is snug against the handle.



Power Up, Final Connections & Testing

1. The Valve Controller will appear offline until it is turned on and it wirelessly connects to a YoLink hub. Turn on the Valve Controller by pressing the SET button until you see the LED blink (red, then green, indicates the Valve Controller 2 has connected to the cloud).

2. In the app, verify the Valve Controller is indicated as online.

3. Connect the valve controller's valve control cable to the control cable of the Bulldog Valve Robot.

4. Connect the valve controller's valve status cable to the valve status cable of the Bulldog Valve Robot.

5. If using the power adapter, and before plugging in the power adapter to the AC power outlet, connect the valve controller's 12VDC input cable to the power adapter cable. Plug in the power adapter at the wall outlet.

6. Test the Valve Controller 2 and Bulldog Valve Robot by pressing the SET button on the controller, and by watching the closing or opening action of the Bulldog and the ball valve. The valve should open and close completely (verify no water is flowing through the valve while closed). Also, listen for an even sound of the motor operating. If the Bulldog sound increases or appears to be straining, this may indicate incorrect or sub-optimal Bulldog installation and/or a mechanical issue with the ball valve (such as too stiff or too much resistance to turning). Return to section K, if needed.

7. Test the operation of the Valve Controller 2 from the app. From the **Rooms** or **Favorite** screen, locate your Valve Controller 2, tap the image, then tap **Close** to turn off the water, and tap **Open** to turn it on.

Refer to the full installation and user guide to complete the setup of your Valve Controller 2 and Bulldog Valve Robot.



Contact Us

We are here for you, if you ever need any assistance installing, setting up or using a YoLink app or product!

Need help? For fastest service, please email us 24/7 at service@yosmart.com

Or call us at **831-292-4831** (US phone support hours: **Monday - Friday, 9AM to 5PM** Pacific)

You can also find additional support and ways to contact us at: www.yosmart.com/support-and-service

Or scan the QR code:



Support
Home Page

Finally, if you have any feedback or suggestions for us, please email us at feedback@yosmart.com

Thank you for trusting YoLink!

Eric Vanzo
Customer Experience Manager

YOLINK

15375 Barranca Parkway
Ste. J-107 | Irvine, California 92618

© 2022 YOSMART, INC IRVINE,
CALIFORNIA