

FlexSwitch

YS5709-UC

Quick Start Guide

Revision Sep. 18, 2023

A Welcome!

Thank you for purchasing YoLink products! We appreciate you trusting YoLink for your smart home & automation needs. Your 100% satisfaction is our goal. If you experience any problems with your installation, with our products or if you have any questions that this manual does not answer, please contact us right away. See the Contact Us section for more info.

Thank you!

Eric Vanzo
Customer Experience Manager

User Guide Conventions

The following icons are used in this guide to convey specific types of information:

Very important information (can save you time!)

Good to know info but may not apply to you

Pour des instructions en français, scannez les codes QR dans la section suivante.

Para obtener instrucciones en español, escanee los códigos QR en la siguiente sección.

B Before You Begin

Please note: this is a quick start guide, intended to get you started on the installation of your FlexSwitch. Download the full Installation & User Guide by scanning this QR code:



Installation & User Guide

You can also find all guides and additional resources, such as videos and troubleshooting instructions, on the FlexSwitch Product Support page by scanning the QR code below or by visiting:

<https://www.yosmart.com/support/YS5709-UC>



Product Support
Support produit
Soporte de producto



Your FlexSwitch connects to the internet via a YoLink hub (SpeakerHub or the original YoLink Hub), and it does not connect directly to your WiFi or local network. In order for remote access to the device from the app, and for full functionality, a hub is required. This guide assumes the YoLink app has been installed on your smartphone, and a YoLink hub is installed and online (or your location, apartment, condo, etcetera, is already served by a YoLink wireless network).

Do review the environmental limitations of the FlexSwitch prior to installation. The FlexSwitch is intended for indoor locations, only!

Do familiarize yourself with this user guide prior to beginning installation. Do ensure that you are comfortable working with electricity and handling the associated tools, or hire a qualified electrician to install your FlexSwitch!

C In the Box



FlexSwitch

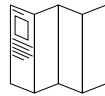

Quick Start Guide



Wire Connectors (4)



2 x AA Batteries
(Installed)

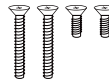

Faceplate Screws
(2)
& Electrical Box
Screws (2)

D Required Items

Tools you will need:

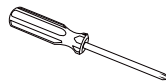

Medium Phillips
Screwdriver

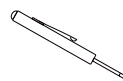

Small Slotted
Screwdriver

Tools you may need:



Wire Strippers or
Cutters



Multimeter

E Get to Know Your FlexSwitch

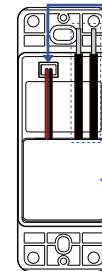

Relay Signal Wires
(Do Not
Disconnect)

Relay Wire Leads

Relay

Status LED Behaviors

- Solid Green
Switch is On
- Solid Red
Switch is Off
- Blinking Green
Control-D2D Pairing in Progress
- Blinking Red
Control-D2D Unpairing in Progress

Programmable Button LED Behaviors

- Blink Green Once
Button One Tap Activated
- Blink Red Once
Button Long Press Activated

F Install the App

If you are new to YoLink, please install the app on your phone or tablet, if you have not already. Otherwise, please proceed to the next section.

Scan the appropriate QR code below or find the "YoLink app" on the appropriate app store.



Download on the
App Store

Apple phone/tablet
iOS 9.0 or higher



Available on
Google Play

Android phone or
tablet 6.0 or higher

F Install the App

Open the app and tap **Sign up** for an account. You will be required to provide a username and a password. Follow the instructions, to set up a new account. Allow notifications, when prompted.

You will immediately receive a welcome email from no-reply@yosmart.com with some helpful information. Please mark the yosmart.com domain as safe, to ensure you receive important messages in the future.

Log in to the app using your new username and password.

The app opens to the **Favorite** screen. This is where your favorite devices and scenes will be shown. You can organize your devices by room, in the **Rooms** screen, later.

G Add Your FlexSwitch to the App

1. Tap **Add Device** (if shown) or tap the scanner icon:

Scanner icon



2. Approve access to your phone's camera, if requested. A viewfinder will be shown on the app.

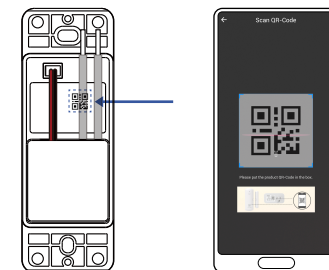

3. Hold the phone over the QR code so that the code appears in the viewfinder. If successful, the **Add Device** screen will be displayed.

You can change the device name and assign it to a room later. Tap **Bind device**.

H Pre-installation

Pre-installation considerations:

The FlexSwitch is a smart wireless switch, with a relay capable of controlling electrical loads including lights, heaters, fans, motors, and pumps. The relay is like a "Form A" type relay – a normally-open set of contacts, but since it is a mechanically-latching relay, it can remain in a closed state indefinitely, with no power applied. The "pigtail" leads of the relay are therefore not designated "common" and "normally-open" or "normally-closed".

The FlexSwitch does not require a ground wire, or any wire to power it, as it is battery-powered.

The FlexSwitch is designed to be an easy replacement for an existing standard or smart light switch, in an existing North American one-gang electrical box, or on one gang of a multi-gang box.. If it is necessary to install the switch in a new box, plastic boxes are recommended over metal, to not effect the wireless range of the FlexSwitch.

The FlexSwitch is not intended for use as a direct replacement of a 3-way switch. To use the FlexSwitch in 3-way style applications, both switches must be replaced, and the wiring will need to be modified, so that only one FlexSwitch controls the circuit. The second switch will act as a remote switch, not connected to the circuit, but acting as a "trigger" for automation settings in the app. These settings in the app will allow the two FlexSwitches to act at 3-way switches, but only one switch actually controls the circuit. It is not in the scope of this quick start guide to cover the modification of the 3-way style wiring, but generally, the wiring must be modified so that only one FlexSwitch can control the circuit. The second FlexSwitch will not be connected to the circuit, but the wiring in that box will need to be modified to complete the electrical circuit that allows the first FlexSwitch to control the circuit.

The FlexSwitch relay can support loads up to 16 amps, resistive, at 250VAC, a maximum current of 20 amps and a maximum voltage of 277VAC, with a maximum switching capacity of 4000VA. Use the FlexSwitch relay to control another relay (that is capable of handling the load) if your application might exceed these specifications.

H Pre-installation, Cont.

The FlexSwitch is designed and intended for indoor use. If using the FlexSwitch in outdoor environments, consider its environmental operating range of -4° to 185°F (-20° to 85° C) and ensure it does not get wet (water damage is not covered by the warranty). Consider the use of weatherproof protective covers or enclosures.

The FlexSwitch can use Control-D2D pairing, to be directly paired to one or more YoLink devices (without the app, without an internet connection, etc.). Refer to the full user guide for instructions on the use of Control-D2D.

I Installation



It is very important that you are comfortable working with electricity before beginning the installation of your FlexSwitch. If not, please hire or consult a proper (experienced, licensed, etc.) electrician.

It is not in the scope of this quick start guide to cover basic electrical concepts, installation or correct methods of handling electrical wiring, circuitry, tools, and devices. It is important that the installer can identify the wires at the FlexSwitch location (including but not limited to the "hot", "load", "neutral" and "ground" wires) and is capable of identifying the type of switch being replaced (e.g. 3-way vs. standard).

Prior to installation, disconnect the power source at the location of the new FlexSwitch. For example, turn off the associated circuit breaker, or remove the fuse. After doing so, it is recommended to test the circuit with a voltage tester or multimeter.

When connecting wires to the FlexSwitch, use "wire nut" type connectors or another method appropriate for the application and as required by any electrical codes that are applicable at your location.

I Installation

1. The uses for the FlexSwitch are many and vary, depending on the equipment being controlled. When using your FlexSwitch to control equipment like a pump, motor, or other relay, please familiarize yourself with the FlexSwitch specifications and limitations prior to installation. If replacing a switch, relay, or button, remove the wiring from that device, and connect it to the FlexSwitch.

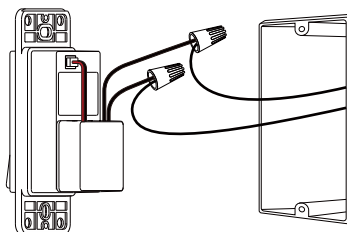

If your FlexSwitch is replacing an existing non-smart switch, remove the switch at this time. If replacing a standard light switch, the two wires connected to the existing switch can be transferred to the two wires of the FlexSwitch relay. Disconnect the hot or 120V wire from the switch and connect it to one wire of the FlexSwitch. Disconnect the other wire from the switch and connect it to the other wire of the FlexSwitch. If a ground wire is connected to the switch, remove it from the switch. It is not needed for the FlexSwitch. Push it back into the electrical box. If the ground wire is a "jumper" or "pigtail" wire, connected to one or more ground wires, you may elect to remove it entirely from the splice.

If your FlexSwitch is replacing a smart switch, the existing switch may have additional wires connected to it, such as a neutral wire. This wire is not needed for the FlexSwitch. Remove it from the existing switch, and then "cap" or insulate the end of the wire with a wire nut or electrical tape. If this wire is a "jumper" or "pigtail" wire, connected to one or more neutral wires in the box, you may elect to remove it entirely from the splice. Be careful to maintain the existing "splice" (connections) between other neutral wires in the box, otherwise other outlets, devices or equipment on the circuit will not function.

I Installation, Cont.

2. Check each wiring connection by gently tugging on each conductor, ensuring it does not pull out of the wire-nut or appear loose. Re-do any that do not pass this test.
3. Gently push the wiring and the switch into the electrical box, then secure the switch to the box using the included or existing screws (if more suitable for the box).
4. Using the included screws, secure the faceplate mounting plate to the switch, then mount the outer part of the faceplate onto the mounting plate, snapping it into place. (If this switch is in a multi-gang box, use the existing faceplate or furnish one suitable for the switches in the electrical box.)

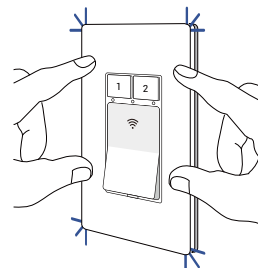
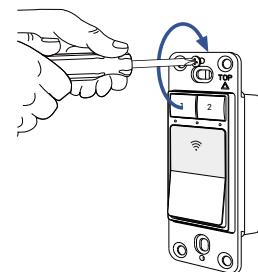

J Testing

1. Restore power to the circuit that serves the FlexSwitch location.
2. Test the FlexSwitch operation by tapping the main button. Verify the controlled device or equipment responds correctly. Test both on and off actions. If it operates correctly, the physical installation is complete and you can refer to the full user guide to complete the settings in the app.

K Contact Us

We are here for you, if you ever need any assistance installing, setting up or using a YoLink app or product!

Need help? For fastest service, please email us 24/7 at service@yosmart.com

Or call us at **831-292-4831** (US phone support hours: **Monday - Friday, 9AM to 5PM** Pacific)

You can also find additional support and ways to contact us at: www.yosmart.com/support-and-service

Or scan the QR code:



Support Home Page

Finally, if you have any feedback or suggestions for us, please email us at feedback@yosmart.com

Thank you for trusting YoLink!

Eric Vanzo
Customer Experience Manager

YOLINK

15375 Barranca Parkway
Ste. J-107 | Irvine, California 92618

© 2023 YOSMART, INC IRVINE,
CALIFORNIA