

# Water Level Monitoring Sensor

YS7904-UC

Quick Start Guide

Revision Apr. 03, 2023

## A Welcome!

Thank you for purchasing YoLink products! We appreciate you trusting YoLink for your smart home & automation needs. Your 100% satisfaction is our goal. If you experience any problems with your installation, with our products or if you have any questions that this manual does not answer, please contact us right away. See the Contact Us section for more info.

Thank you!

Eric Vanzo  
Customer Experience Manager

The following icons are used in this guide to convey specific types of information:

Very important information (can save you time!)

Pour des instructions en français, scannez les codes QR dans la section suivante.

Para obtener instrucciones en español, escanee los códigos QR en la siguiente sección.

## B Before You Begin

Please note: this is a quick start guide, intended to get you started on the installation of your Water Level Monitoring Sensor. Download the full Installation & User Guide by scanning this QR code:



Installation & User Guide

You can also find all current guides and additional resources, such as videos and troubleshooting instructions, on the Water Level Monitoring Sensor Product Support Page by scanning the QR code below or by visiting:

<https://shop.yosmart.com/pages/water-level-monitoring-sensor-product-support>



Product Support  
Support produit  
Soporte de producto



Your Water Level Monitoring Sensor connects to the internet via a YoLink hub (SpeakerHub or the original YoLink Hub), and it does not connect directly to your WiFi or local network. In order for remote access to the device from the app, and for full functionality, a hub is required. This guide assumes the YoLink app has been installed on your smartphone, and a YoLink hub is installed and online (or your location, apartment, condo, etcetera, is already served by a YoLink wireless network).

## C In the Box

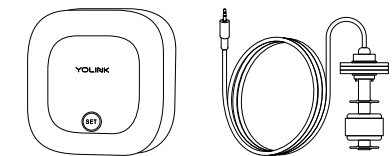

Water Level Monitoring Sensor

Float Switch



Mounting Hook

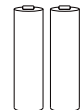

2 x AAA Batteries (Pre-Installed)

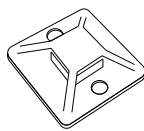

Cable Tie Mount



Cable Tie

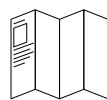

Quick Start Guide

## D Required Items

The following items may be required:



Double-Sided Mounting Tape



Rubbing Alcohol Pads

## E Get to Know Your Sensor

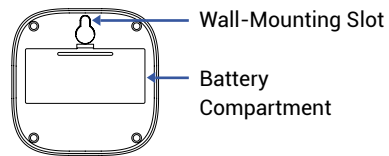

### Alarm Tones

- **One Beep**  
Device power-up/button pressed
- **Two Beeps**  
Water Alert  
(Two beeps every 2 seconds for the first minute. Two beeps every 5 seconds for the next 12 hours. Sustaining two beeps once a minute after 12 hours)

### Status LED

\* Not visible while there is no operation with the SET button or while device is in normal monitoring status

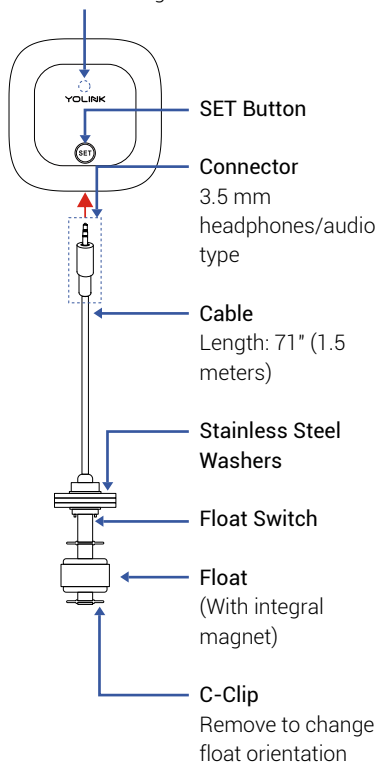

## E Get to Know Your Sensor, Cont.

### LED Behaviors

- Blinking Red Once**  
Water Alert  
Water Detected or Water Not Detected (Depending on Mode)
- Blinking Green**  
Connecting to Cloud
- Fast Blinking Green**  
Control-D2D Pairing in Progress
- Slow Blinking Green**  
Updating
- Fast Blinking Red**  
Control-D2D Unpairing in Progress
- Blinking Red And Green Alternately**  
Restoring to Factory Defaults

## F Install the App

If you are new to YoLink, please install the app on your phone or tablet, if you have not already. Otherwise, please proceed to the next section.

Scan the appropriate QR code below or find the "YoLink app" on the appropriate app store.



Download on the App Store

Apple phone/tablet iOS 9.0 or higher



Available on Google Play

Android phone/tablet 4.4 or higher

Open the app and tap **Sign up** for an account. You will be required to provide a username and a password. Follow the instructions, to set up a new account. Allow notifications, when prompted.

## F Install the App, Continued

You will immediately receive a welcome email from no-reply@yosmart.com with some helpful information. Please mark the yosmart.com domain as safe, to ensure you receive important messages in the future.

Log in to the app using your new username and password.

The app opens to the **Favorite** screen. This is where your favorite devices and scenes will be shown. You can organize your devices by room, in the **Rooms** screen, later.

Refer to the full user guide and online support for instructions on the use of the YoLink app.

## G Add Your Sensor to the App

1. Tap **Add Device** (if shown) or tap the scanner icon:

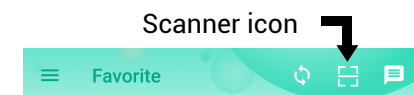

2. Approve access to your phone's camera, if requested. A viewfinder will be shown on the app.

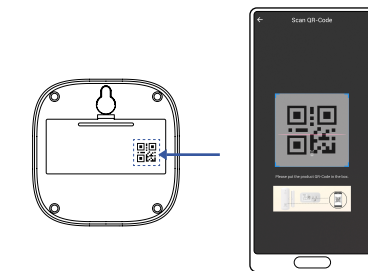

3. Hold the phone over the QR code so that the code appears in the viewfinder. If successful, the **Add Device** screen will be displayed.

4. Follow the instructions to add your Water Level Monitoring Sensor to the app.

## H Power-Up

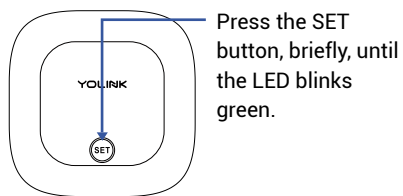

## I Installation

### Sensor use considerations:

The Water Level Monitoring Sensor is a variant of the Water Leak Sensor 2 (rope/cable style water sensor), which also shares the main sensor body with the Water Leak Sensor 3 (probe cable type water sensor). All three sensors are generally identical in the app, but settings you make in the app determine the behavior of the sensor.

When using this sensor with a float switch, for monitoring the presence of absence of a liquid with water, in the app, you will define either liquid-detected, or no-liquid-detected, as "normal". Depending on the mode you select, the sensor will alert, and you will be notified if the liquid level drops below the float switch, OR if it rises to the float switch.

It is important to note, that even if you define "no liquid detected" as an alert (and therefore "liquid detected" as normal), you can still create some automations that will respond to the change of state from liquid detected to no liquid detected. An example of this approach, is you want to receive a push notification and SMS when no liquid is detected (something is wrong), and you want to receive a push notification, only, when liquid is detected (normal; the level of the liquid is good). You can create an automation using the Notification behavior, to receive a push notification when liquid is detected again.

## I Installation, Continued

### Sensor location considerations:

Before installing your Water Level Monitoring Sensor, consider the following important factors:

1. This device is intended for indoor use, only. If used outdoors, the sensor body should be protected from the elements, in an environmental enclosure, for example, and the environmental conditions (temperature, humidity, etc.) should be within the specified range for the sensor (refer to online support information for the full specifications for this sensor). The sensor body should not be installed where it may get wet (indoors or outdoors).
2. The Water Level Monitoring Sensor has an integral sounder alarm (piezo sounder). Use of the sounder is optional, can it can be disabled in the app settings. Use of the sounder will reduce the total battery life.
3. The Water Level Monitoring Sensor is typically mounted on a wall or on a stable vertical surface (e.g. post or column).
4. If needed, you can add extension cables between the float switch cable and the sensor, to extend the total cable distance. Use standard 3.5 mm headphones type cables appropriate for the application (e.g. outdoor rated/waterproof)

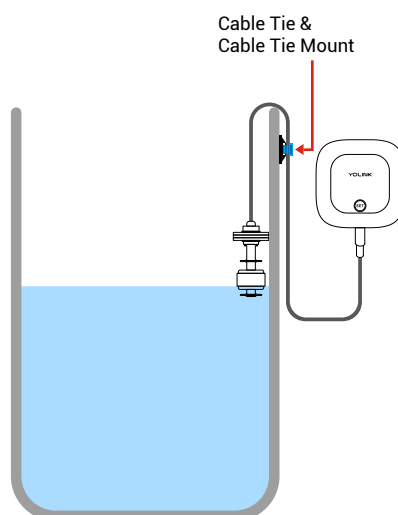

### Float switch location & installation considerations:

The float switch is designed for and intended to be suspended into the tank, container, etc. The stainless steel washers installed on the float switch have two purposes. The weight of the washers will ensure that the float switch hangs to the appropriate level in the tank, and that the cable does not coil or bend, resulting in undesired results from the float switch. Also, the wider diameter of the washers ensures the float switch can be placed against a sidewall of the tank/container, allowing the float switch to move freely.

It is the responsibility of the installer to secure the cable so that the float switch position does not change later. For example, use zip cords/tie wraps to secure the cable to a fixed object.



Avoid damaging the cable when securing it. If you use tie wraps, do not crimp or smash the cable by overtightening the tie wraps.

### Float switch configuration:

The float switch has two float positions – high and low. When installed correctly in a vertical position, if a liquid is present, the float will rise to the high position. If there is no liquid present, it falls to the low position, by gravity. But electrically, the float switch can give four different outputs to the sensor:

- Float high, closed circuit
- Float high, open circuit
- Float low, closed circuit
- Float low, open circuit

The float switch has an internal reed switch, and the small magnet inside the float magnetically opens or closes the circuit to the Water Level Monitoring Sensor. As shipped, your float switch should be "closed" or "shorted" when the float is in the high position and "open" when the float is in the low position. If you need to change this operation, you can do so by removing the c-clip, removing the float, and then reinstalling the float upside-down, then reinstalling the c-clip. The c-clip can be removed by gently widening the opening of the "C" shape, by hand or with a tool, like a screwdriver. Push it back in place on the float switch to install it, noting the slot for the c-clip that is in the end of the float switch. It may be helpful to have a multimeter to test the float switch configuration, but otherwise, after connected to the sensor, the open/-closed status can be checked.

### Install the float switch

1. Before installing the float switch, determine the method of securing the cable.
2. Place the float switch at the desired level in the tank/container, based on your application (liquid detected is normal, or no liquid detected is normal).
3. Secure the cable, while verifying the height of the float switch is correct.

### Install the mounting hook

1. Before installing the Water Level Monitoring Sensor, check the length of the cable, ensuring there is enough, for the desired sensor location.
2. Clean the mounting surface with rubbing alcohol or similar cleaner or degreaser that will clean the surface without leaving a residue that might effect the adhesion of the mounting tape on the bracket. The surface must be clean, dry and free of dirt, oils, grease, or other cleaning agent residue.

3. Remove the protective plastic from the mounting tape on the back of the mounting hook.

4. With the hook facing up, as shown, press it firmly against the mounting surface and maintain pressure for at least 5 seconds.

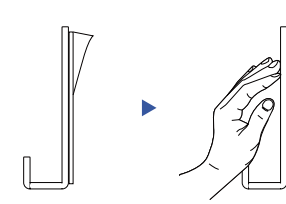

### Install and test the Water Level Monitoring Sensor

1. Insert the float switch cable connector into the Water Level Monitoring Sensor.
2. Using the slot on the back of the sensor, hang the sensor on the mounting hook. Ensure it is secure by gently tugging on it.
3. It is important that you test your sensor, to ensure it will work properly when needed! To properly test it, you may need to change settings in the app.

Refer to the full installation and user guide and/or the product support page, to complete the settings in the YoLink app.

## J Contact Us

We are here for you, if you ever need any assistance installing, setting up or using a YoLink app or product!

Need help? For fastest service, please email us 24/7 at [service@yosmart.com](mailto:service@yosmart.com)

Or call us at **831-292-4831** (US phone support hours: **Monday - Friday, 9AM to 5PM Pacific**)

You can also find additional support and ways to contact us at: [www.yosmart.com/support-and-service](http://www.yosmart.com/support-and-service)

Or scan the QR code:



Support  
Home Page

Finally, if you have any feedback or suggestions for us, please email us at [feedback@yosmart.com](mailto:feedback@yosmart.com)

Thank you for trusting YoLink!

Eric Vanzo  
Customer Experience Manager

**YO LINK**

15375 Barranca Parkway  
Ste. J-107 | Irvine, California 92618

© 2023 YOSMART, INC IRVINE,  
CALIFORNIA